

MIT OpenCourseWare
<http://ocw.mit.edu>

4.500 Introduction to Design Computing
Fall 2008

For information about citing these materials or our Terms of Use, visit: <http://ocw.mit.edu/terms>.

4.500

Digital Fabrication



Design Tools

Design by Physical Reasoning

Description

Rapid Prototyping



Generative
Methods
(Design Tools)

Description

CNC Fabrication



Digital Printing = Digital Fabrication

- Flexibility
- Precision
- Repetition

Rapid Prototyping

3D Printing

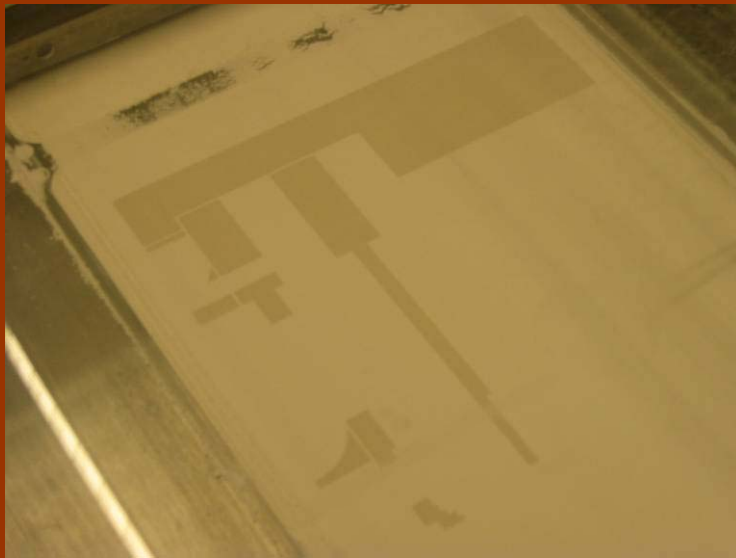
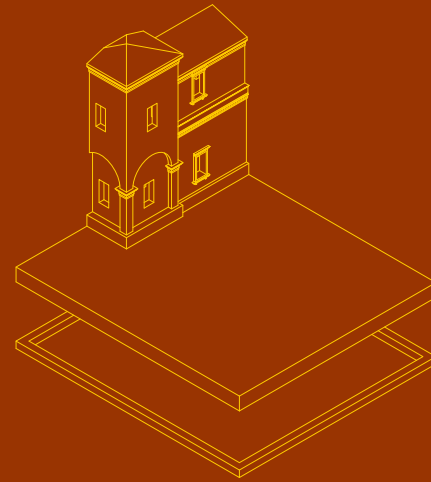

Rapid Prototyping

3D Printing

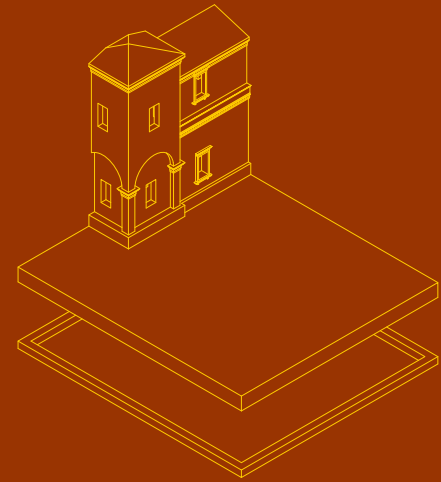

Rapid Prototyping

Laser Cutting

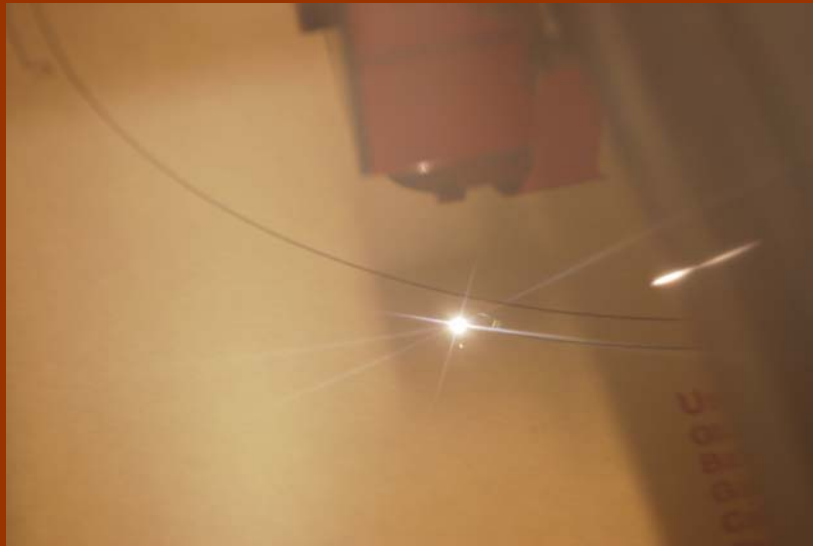

Milling

Dense Foam Routing

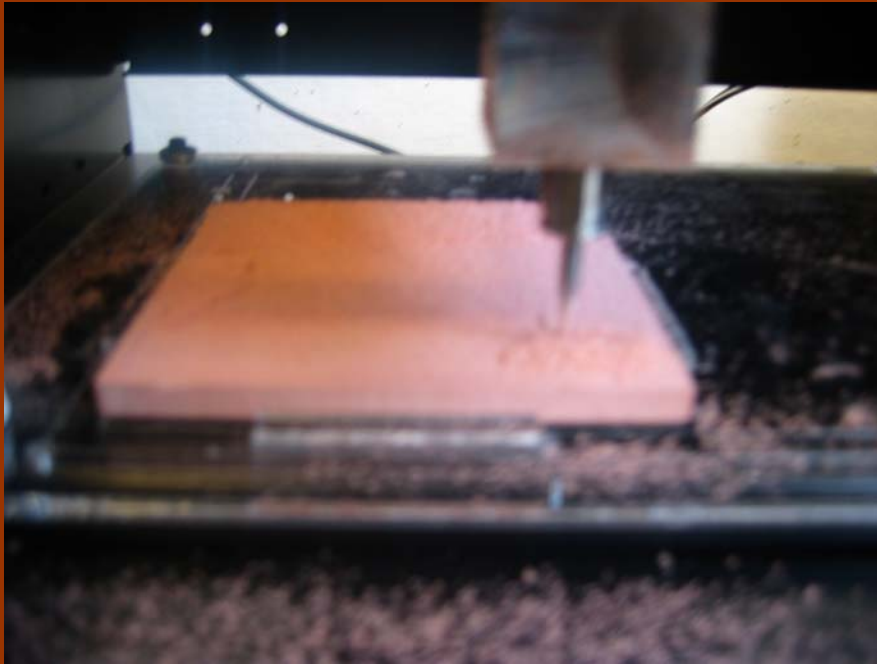

CNC Fabrication

Wood Routing



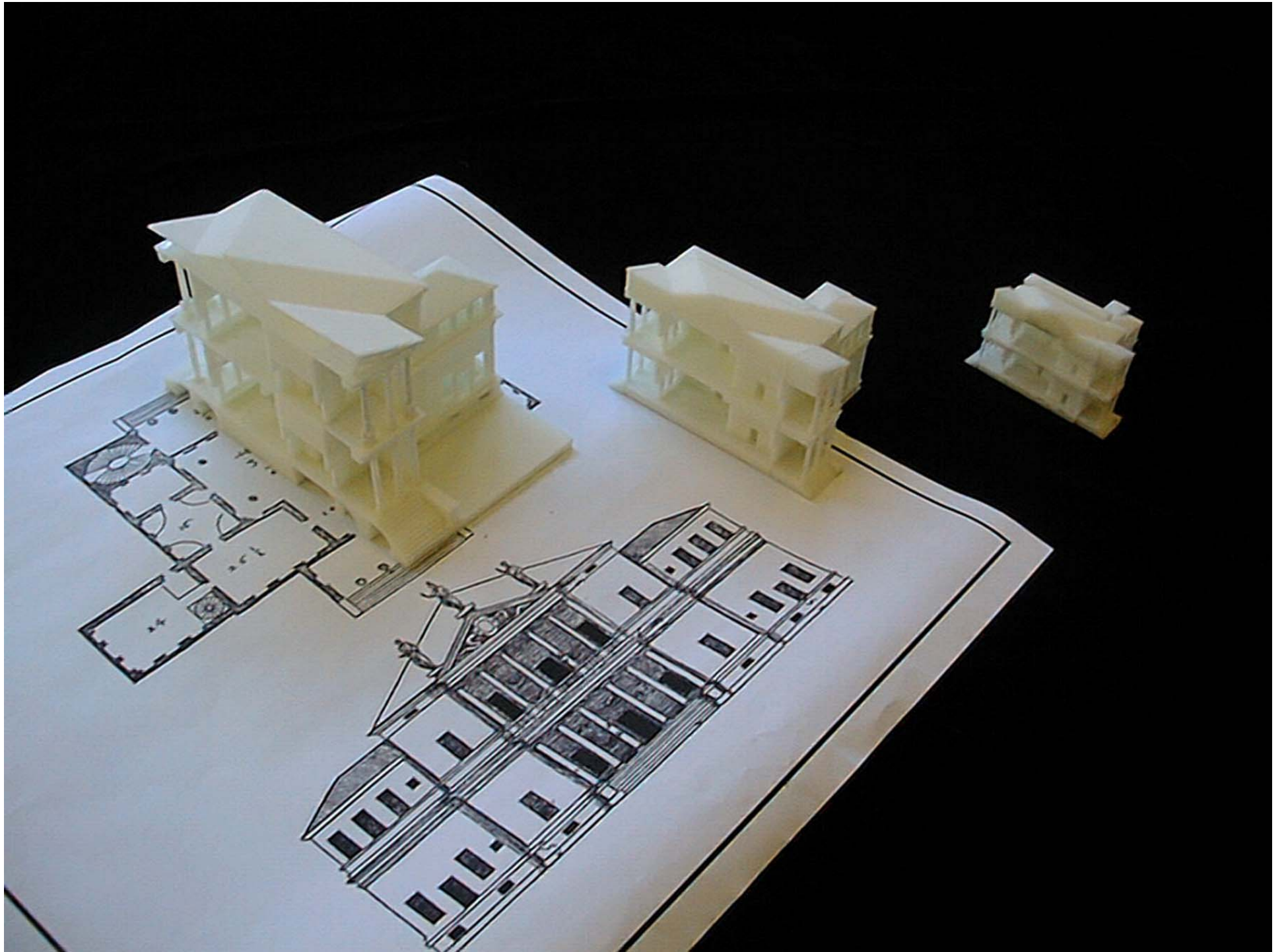

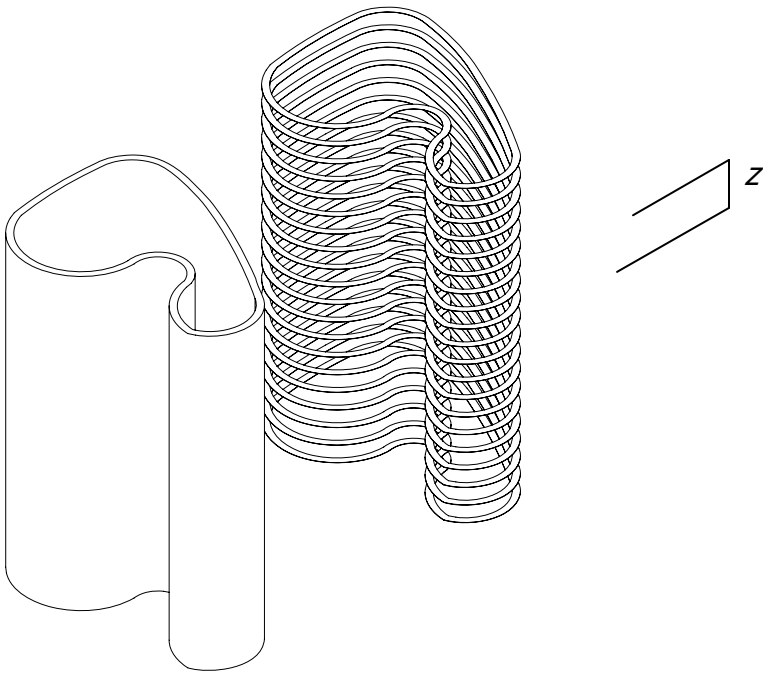

A) 3D Printer

- Metal
- Plaster
- Cornstarch
- Ceramics

B) FDM

- ABS Plastic
- Rubber
- Wax

C) Stereo Lithography

- Resin

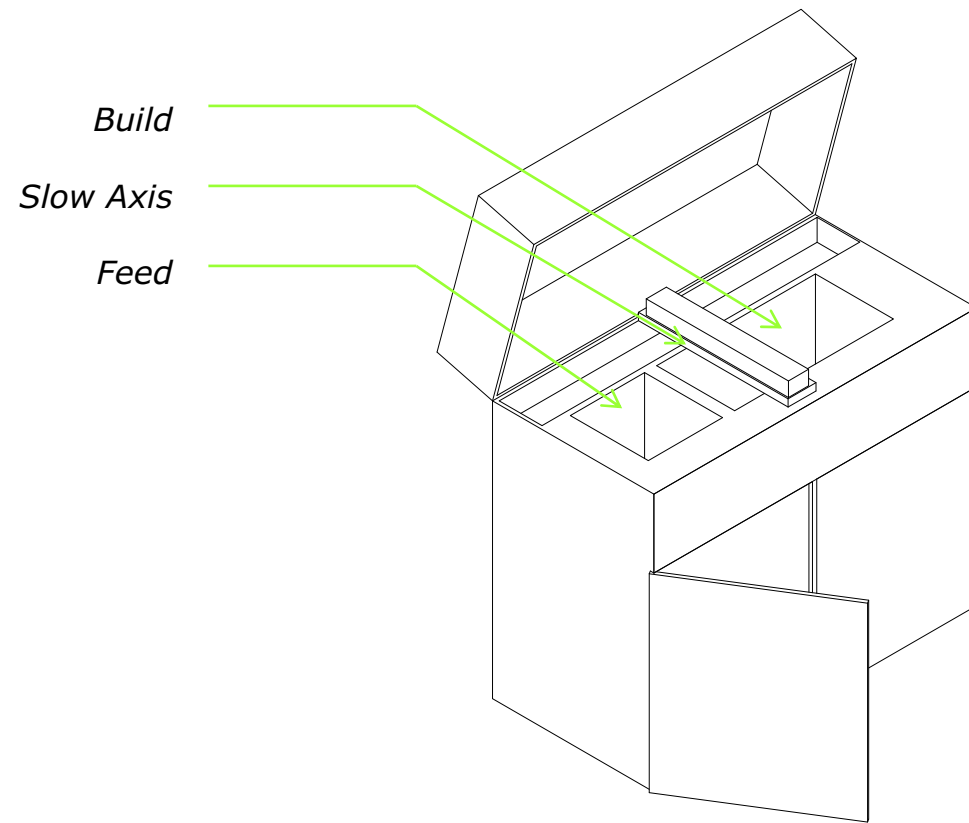

-3D Printer

- Metal
- Cornstarch

-Plaster

- Ceramics



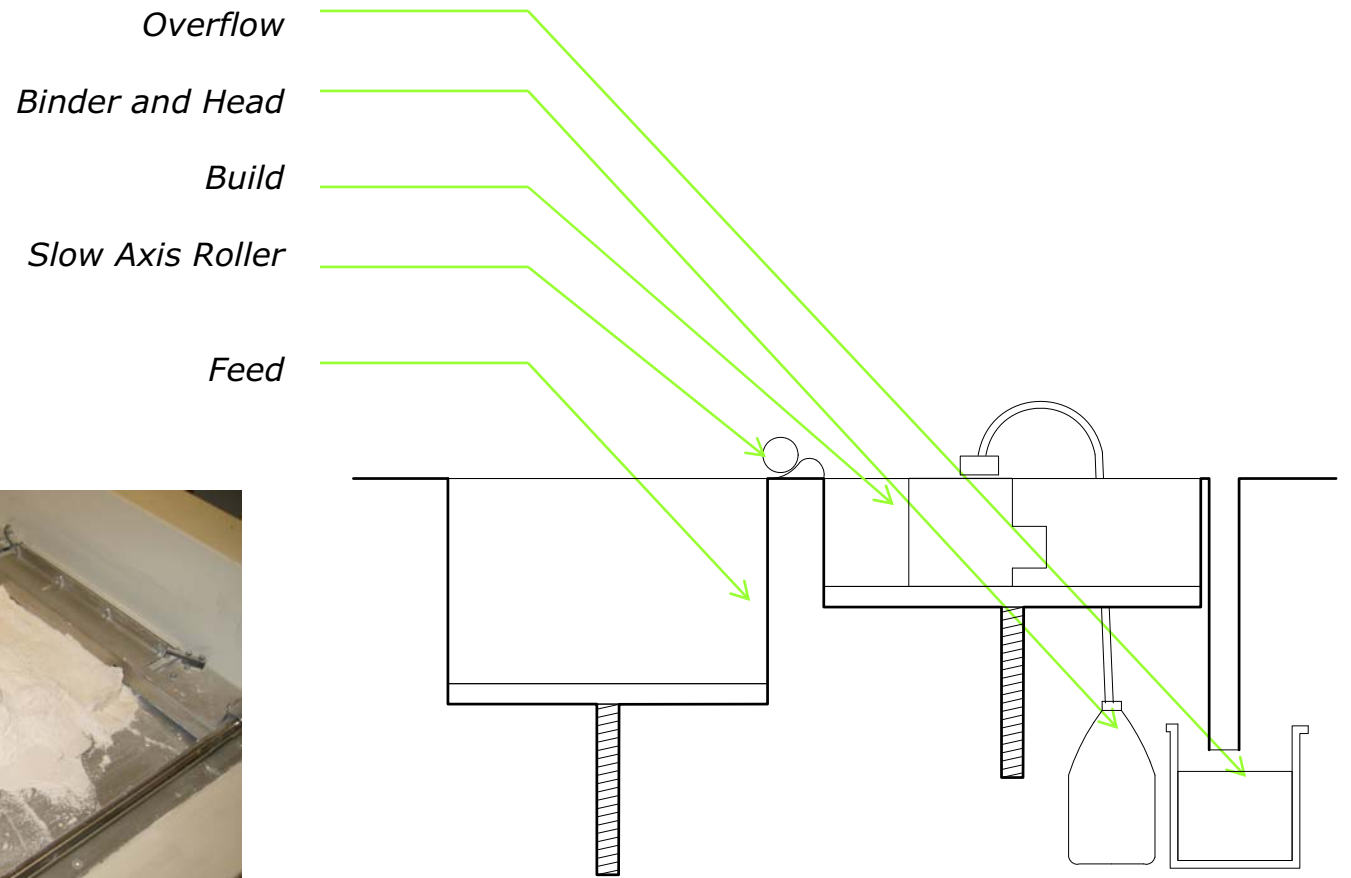

Open Spaces

Plaster

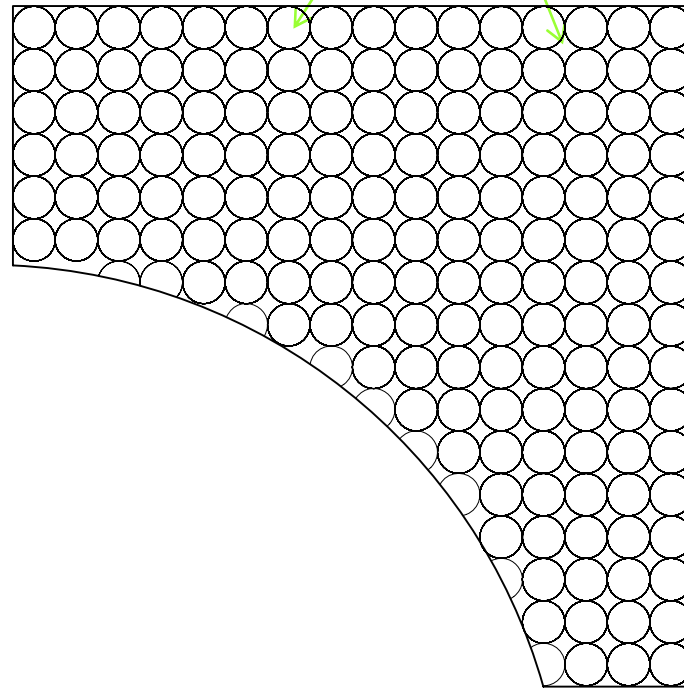

- *Advantages*
 - *Speed*
 - *Self Supporting*
 - *Low Cost*
- *Disadvantages*
 - *Low Strength*
 - *Required Post Processing*

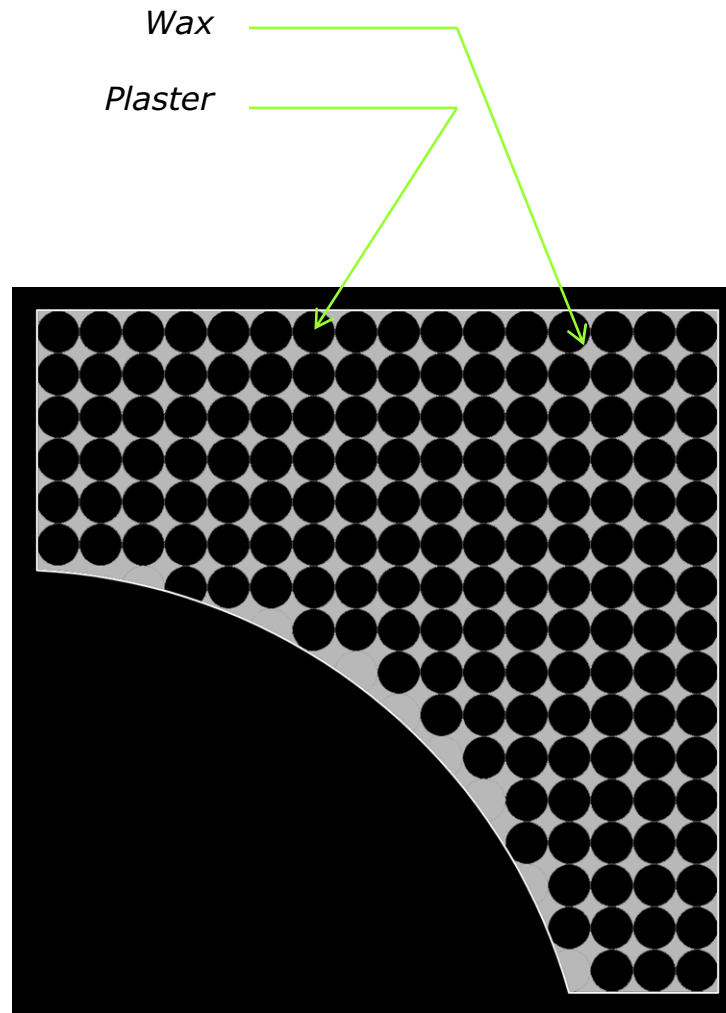







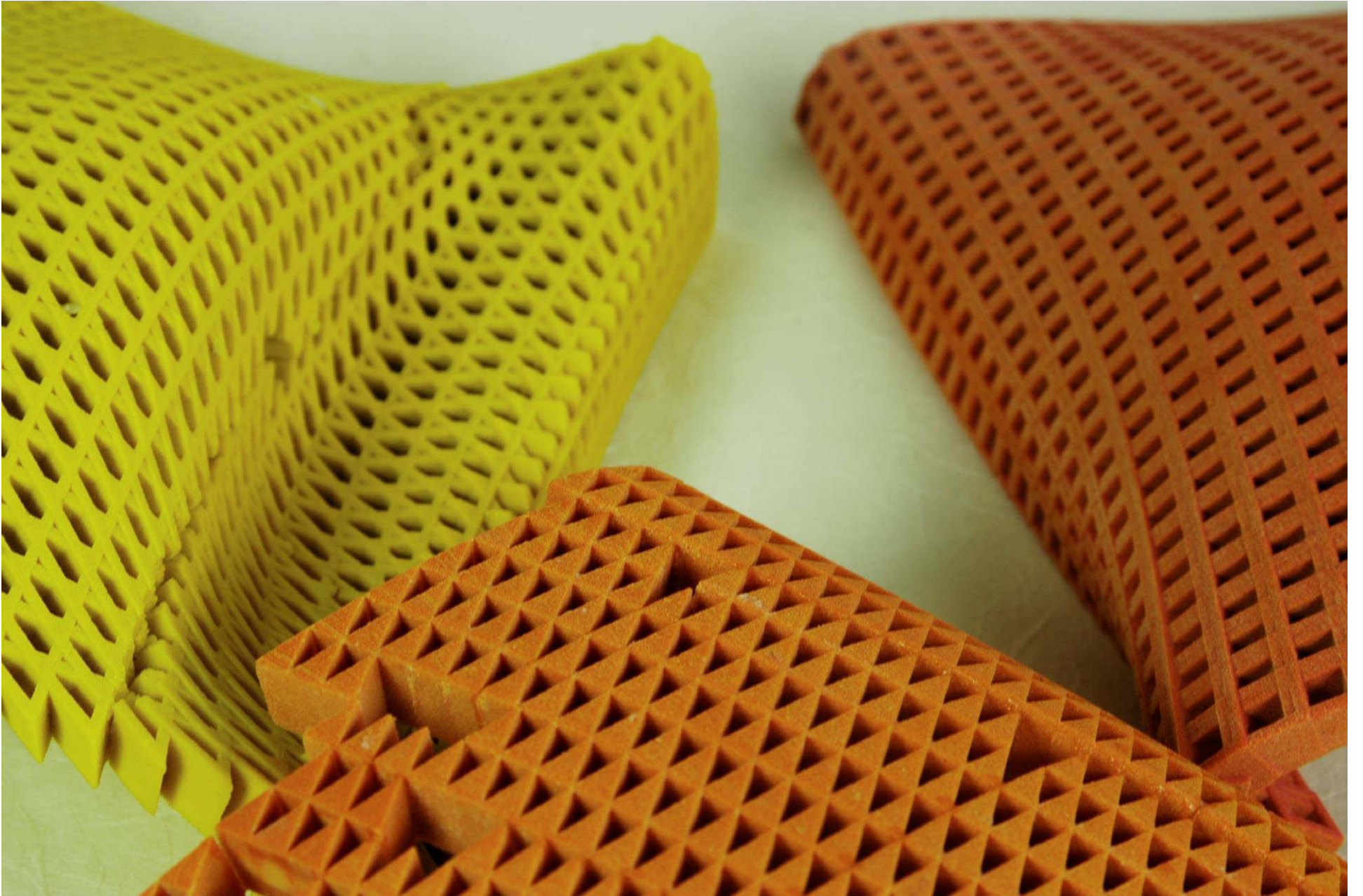

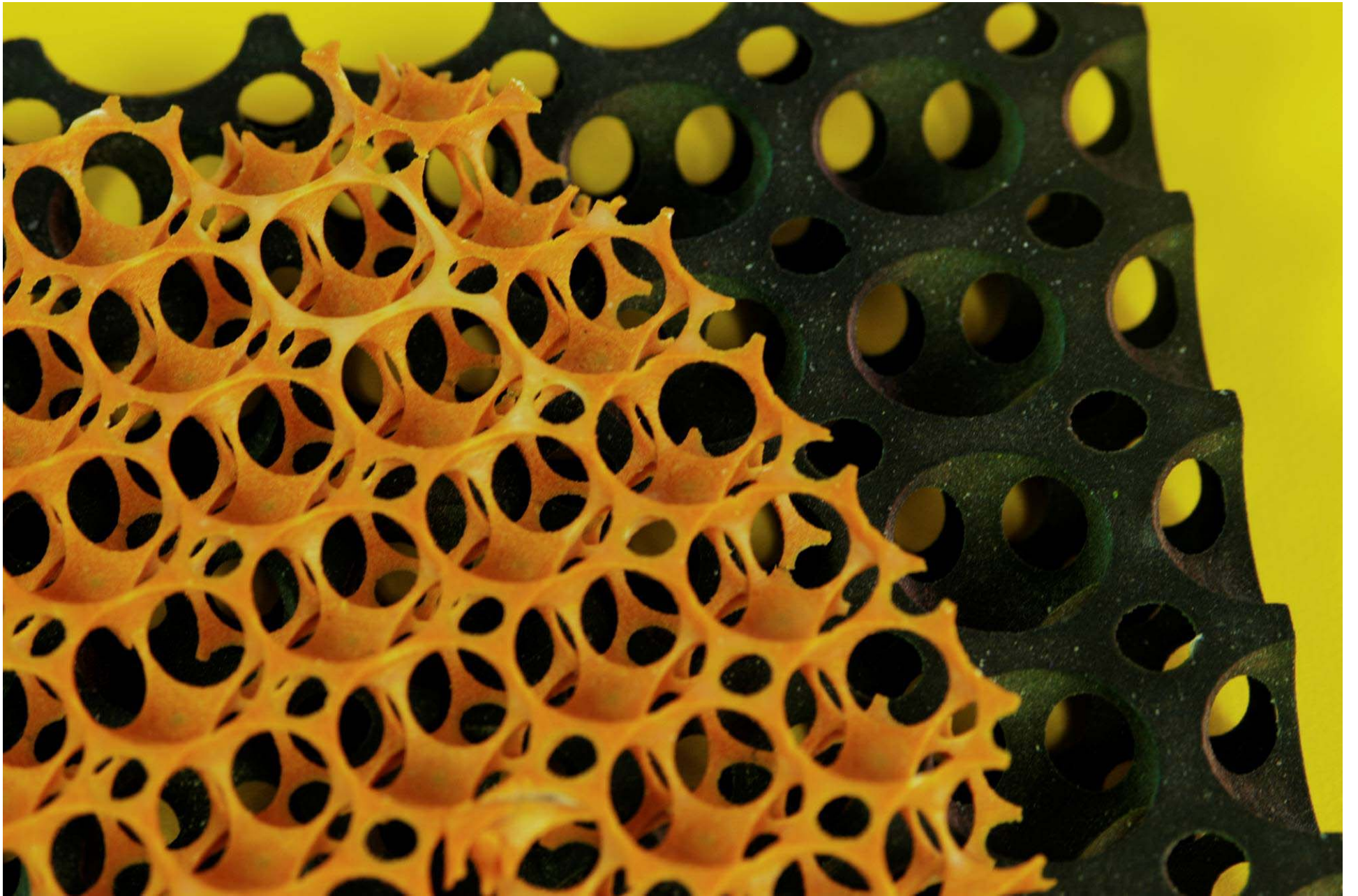

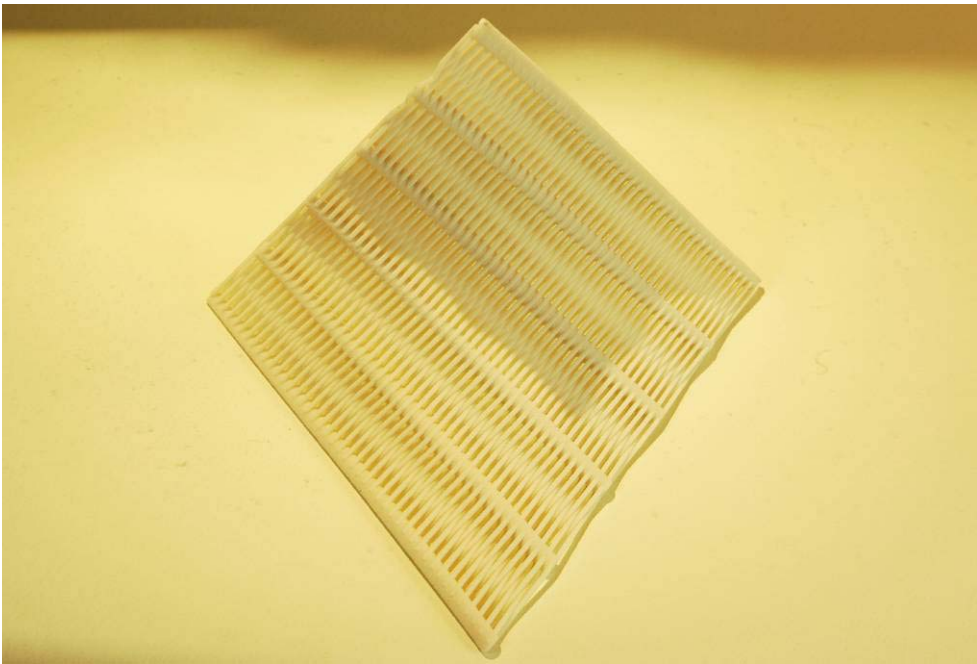
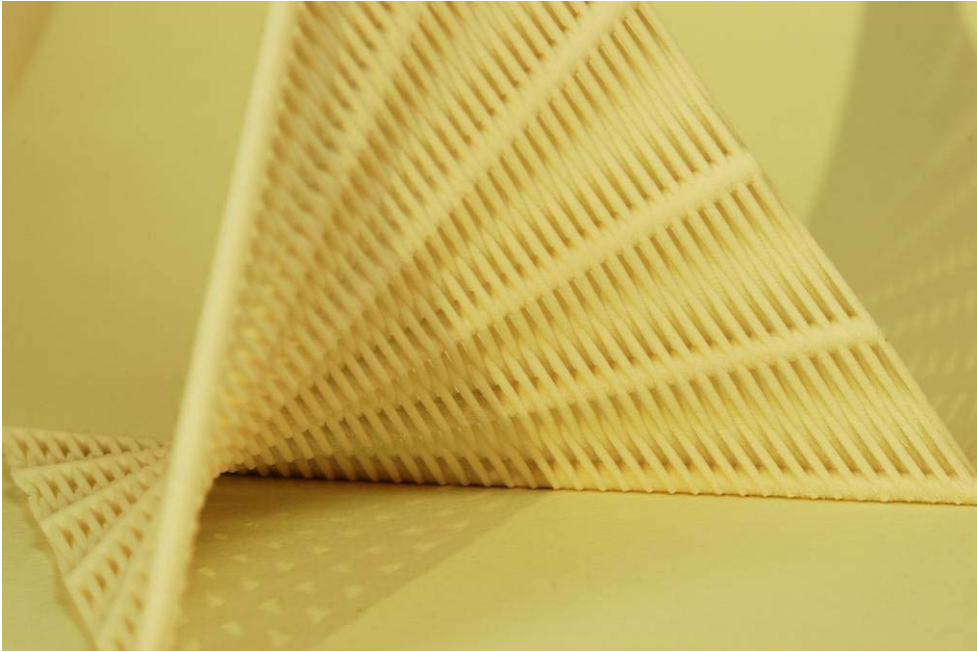

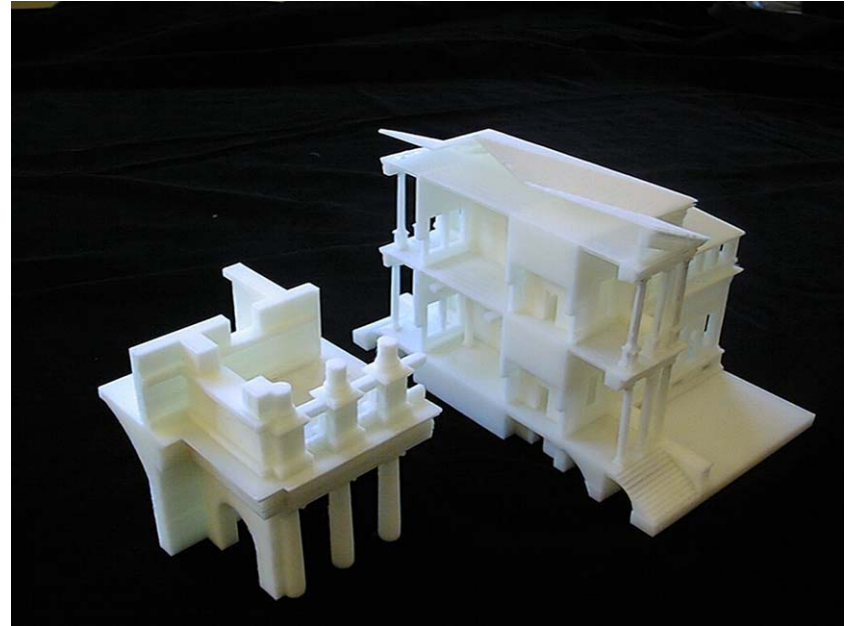

[b]

Strata Sys

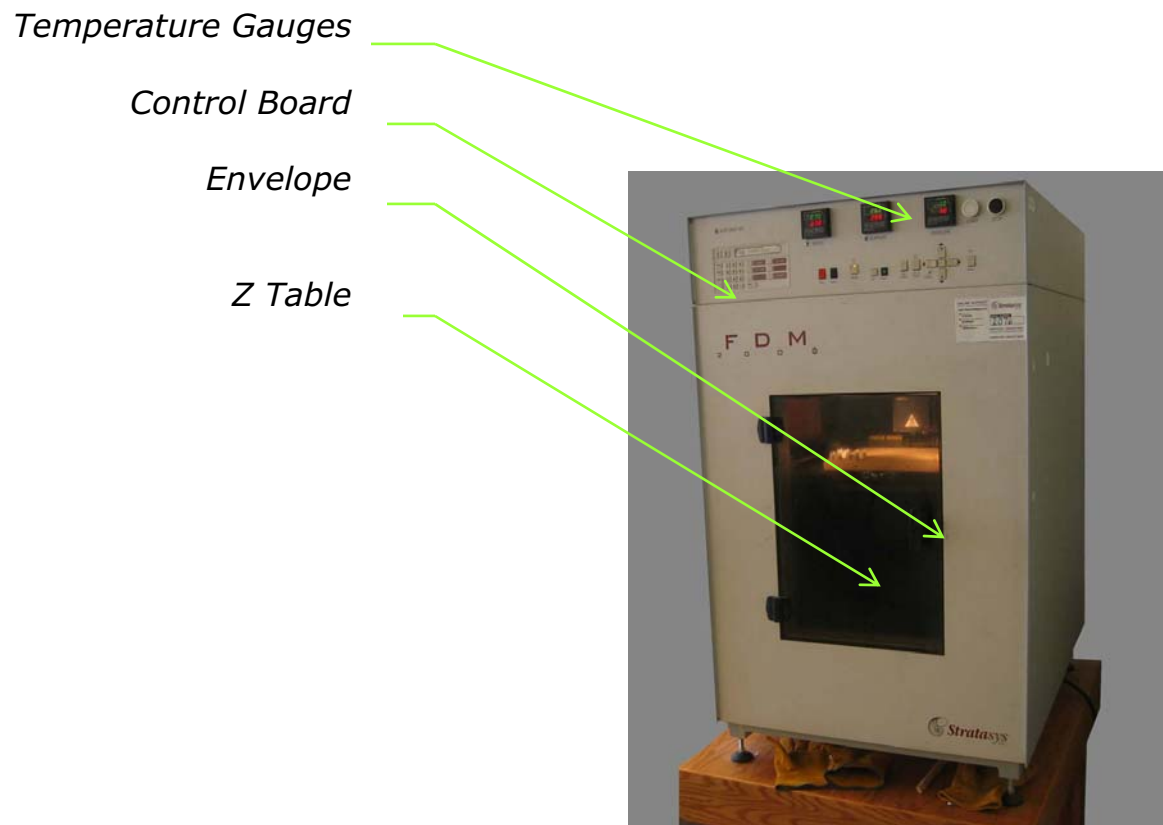
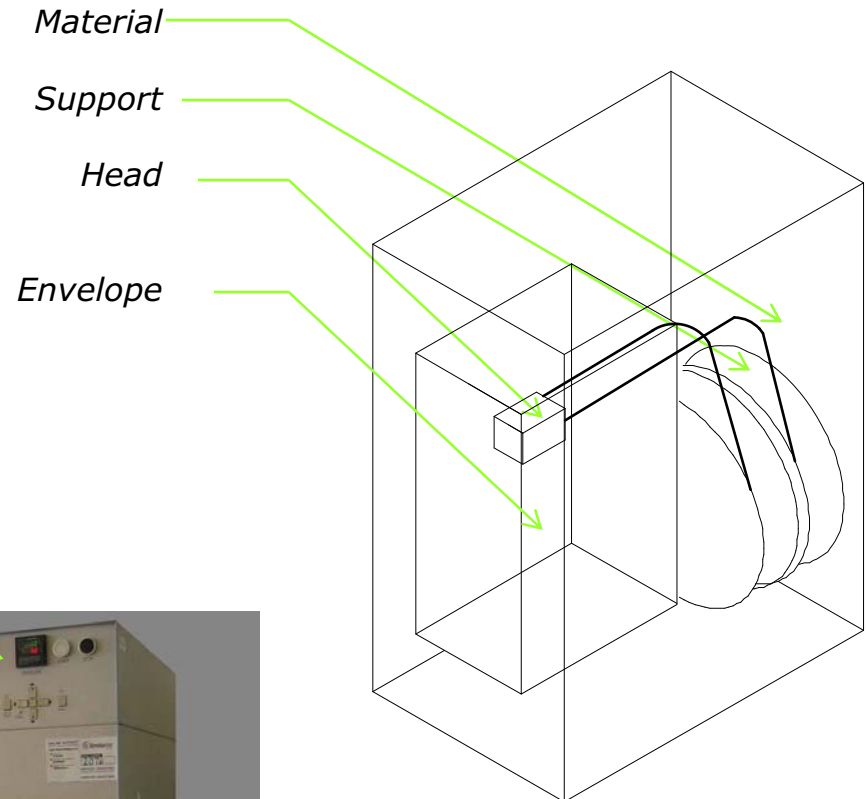

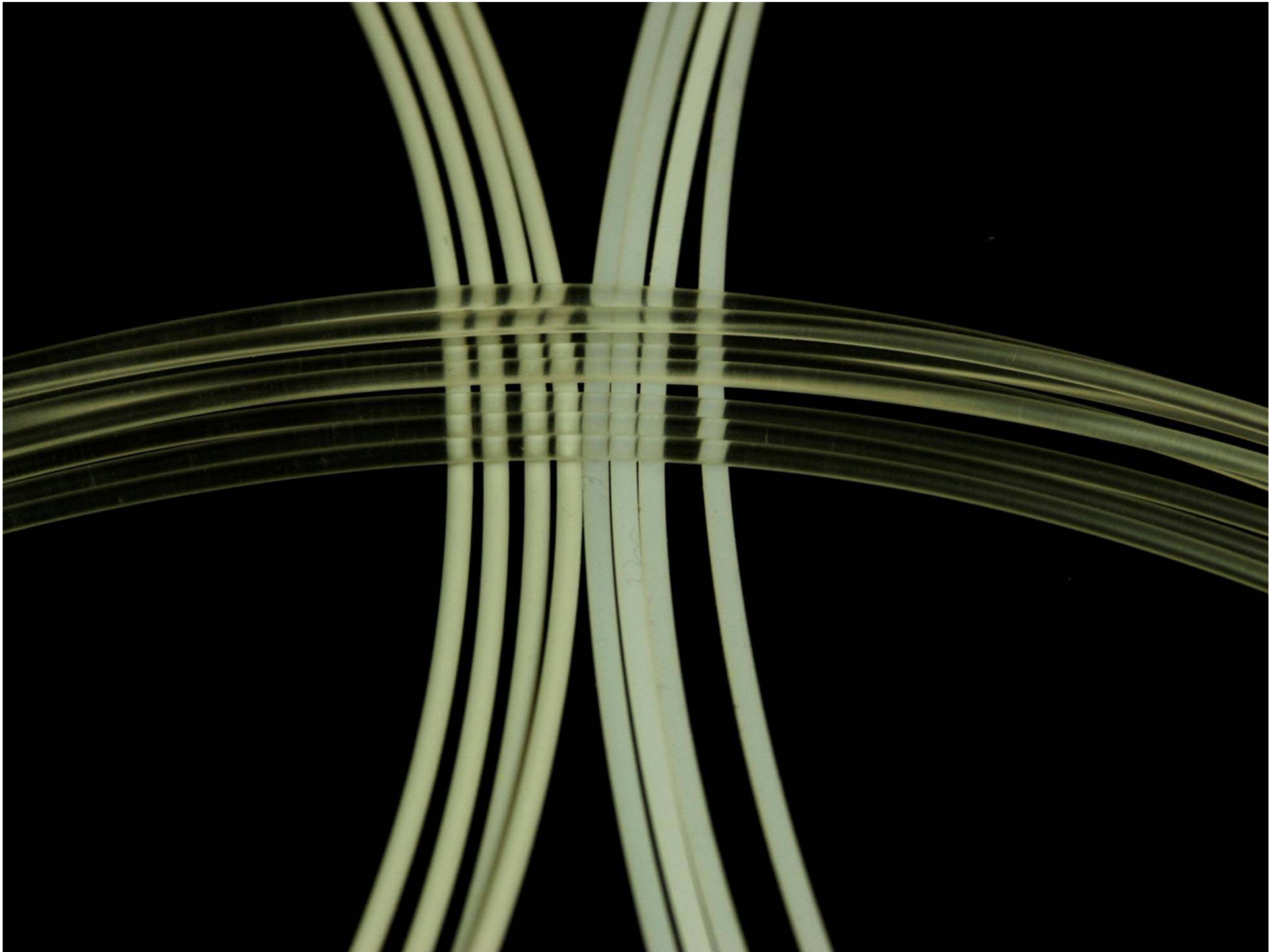

Head
Support
Material
Material
Support Base

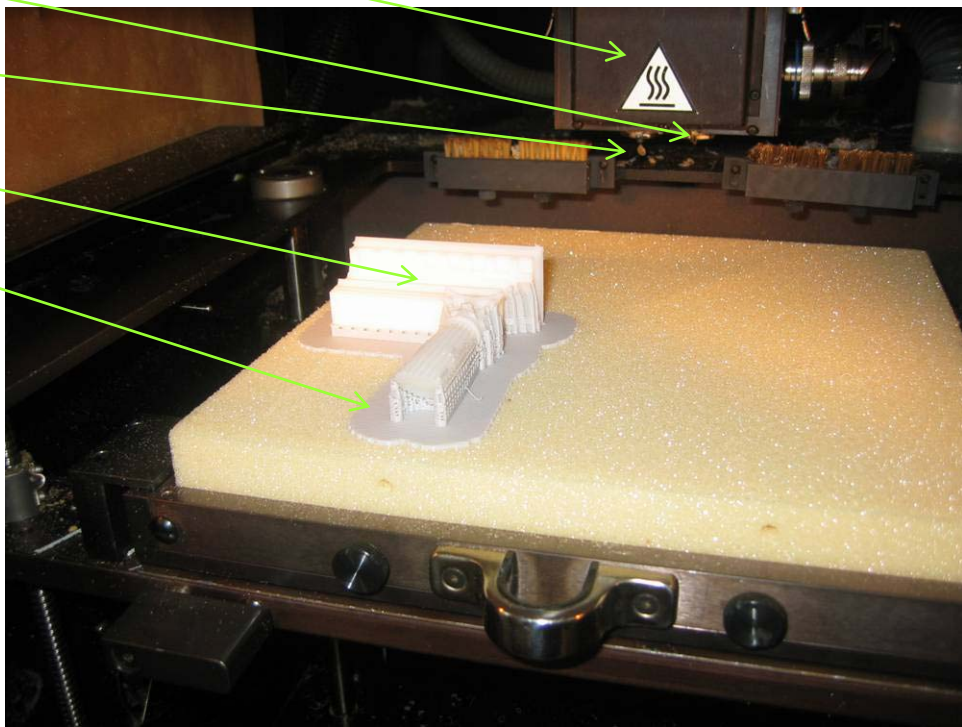

Heating Elements

Tips

Drive Wheels

Filament

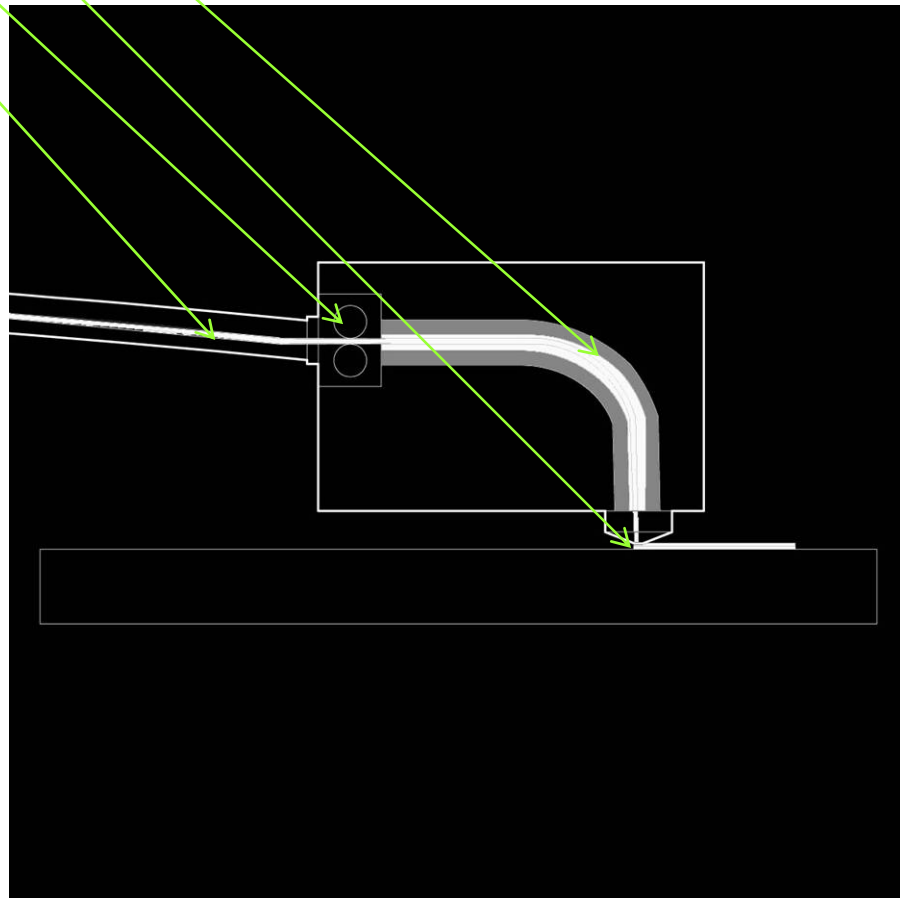

ABS Material .010
ABS Support Base .010

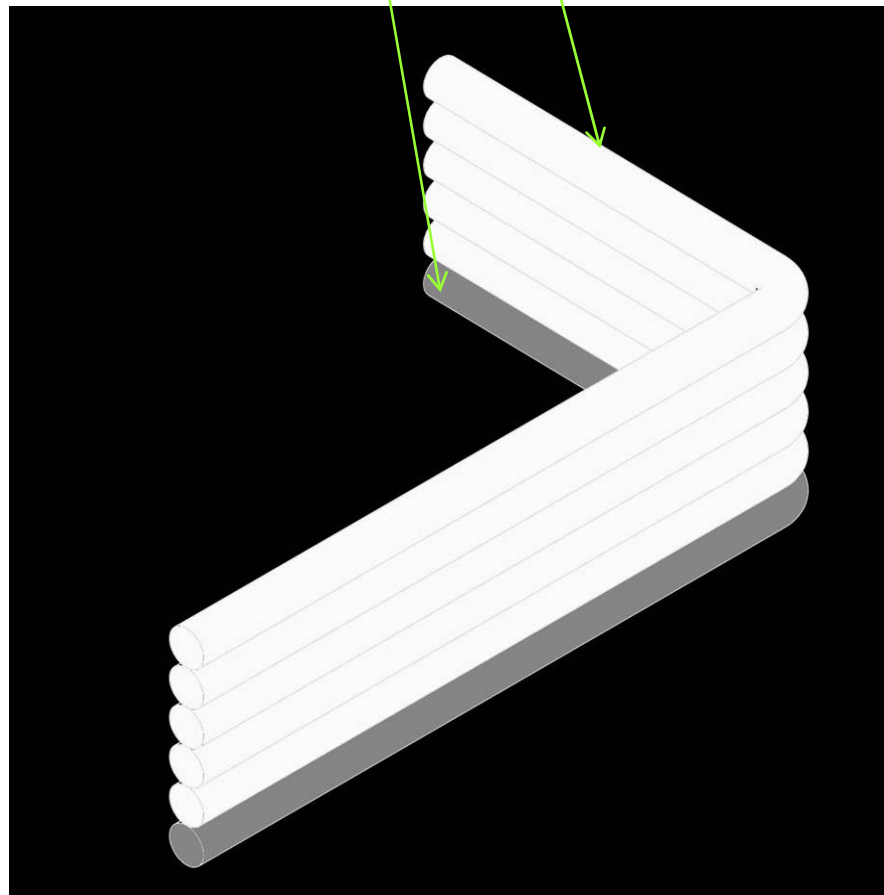

-Advantages

- *Strong*
- *Minimal Post Processing*

-Disadvantages

- *Slow*
- *Porous*
- *Hates Voids*
- *High Cost to Operate*

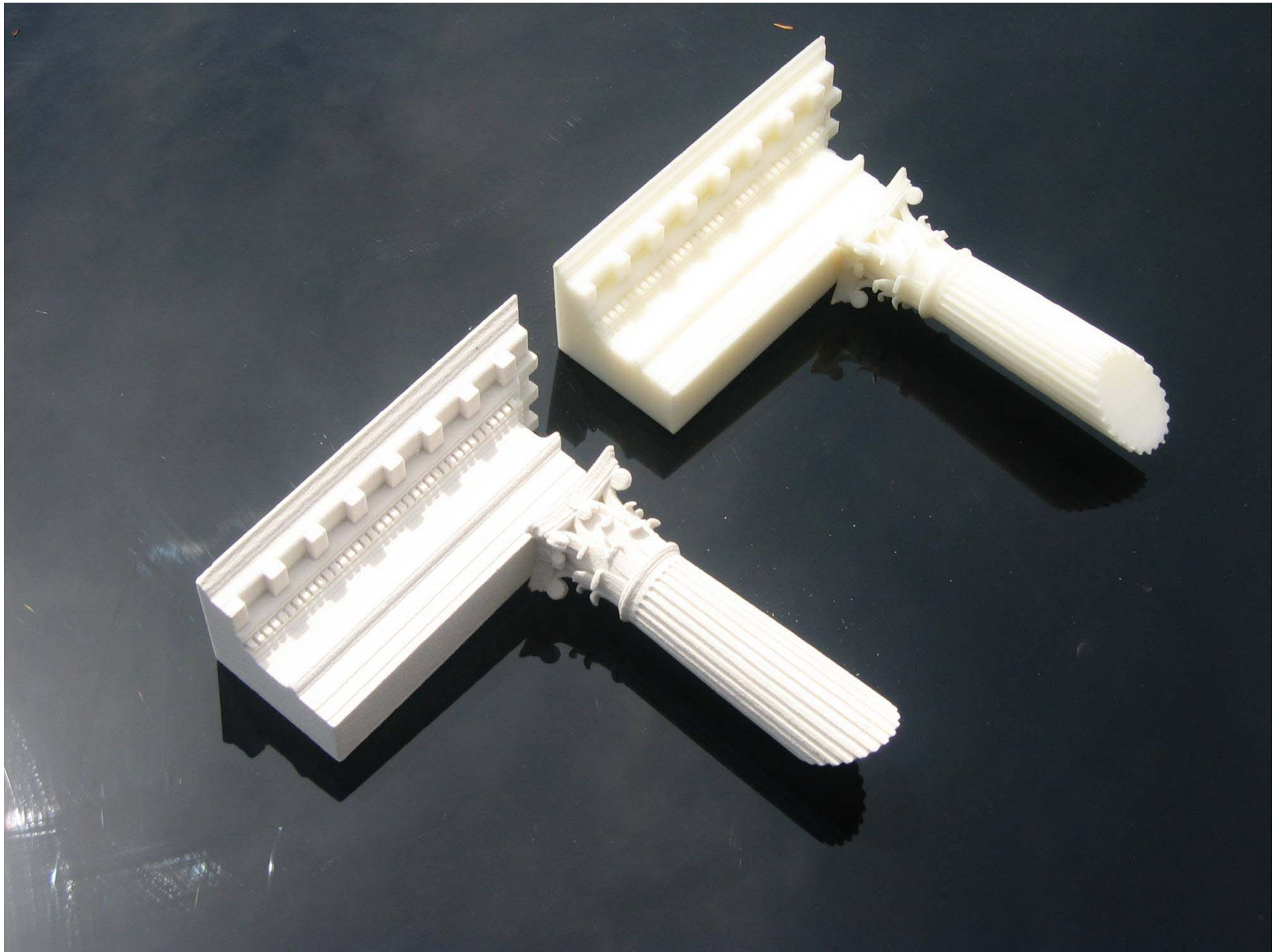

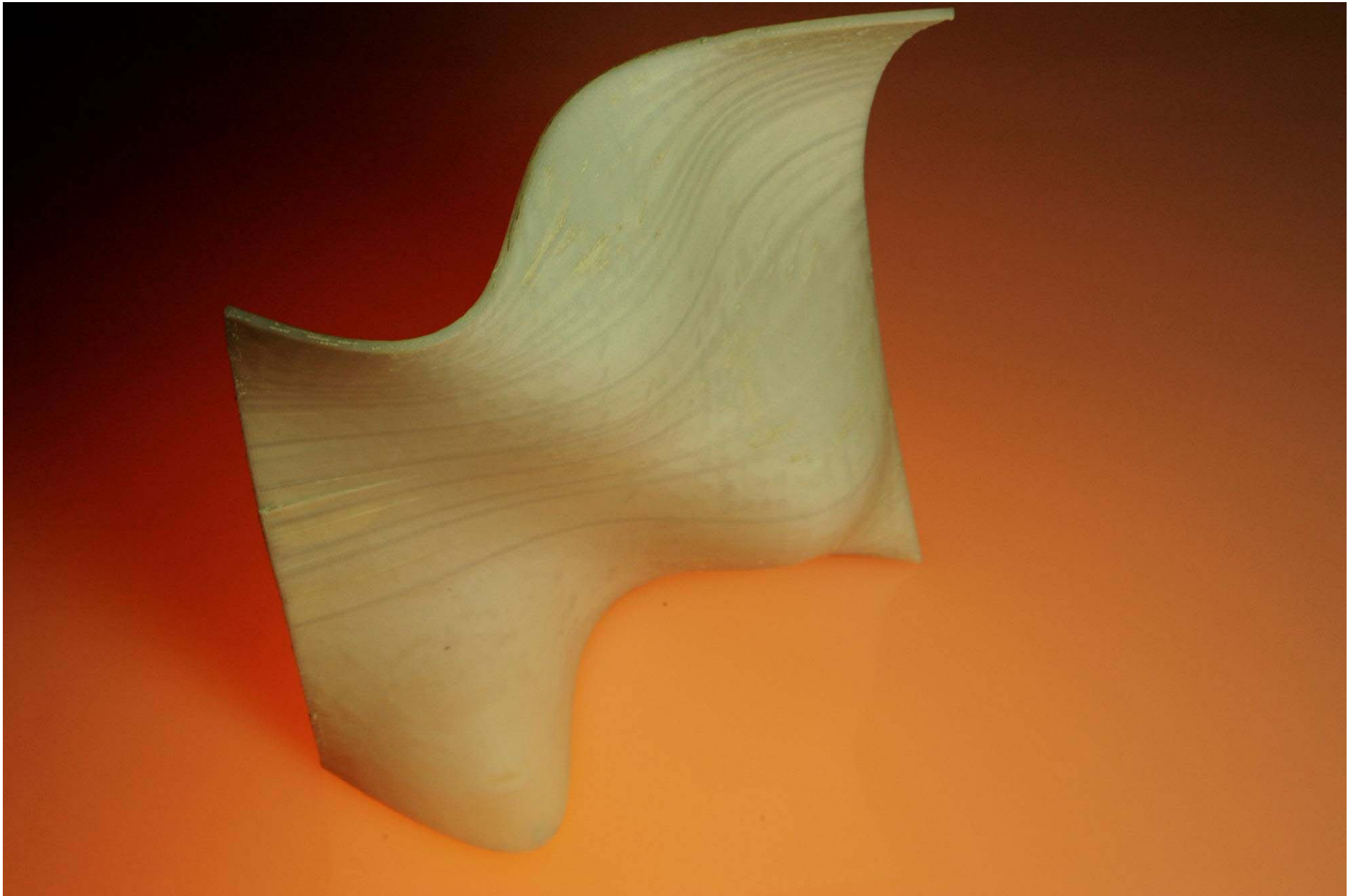





[c]

Stereolithography

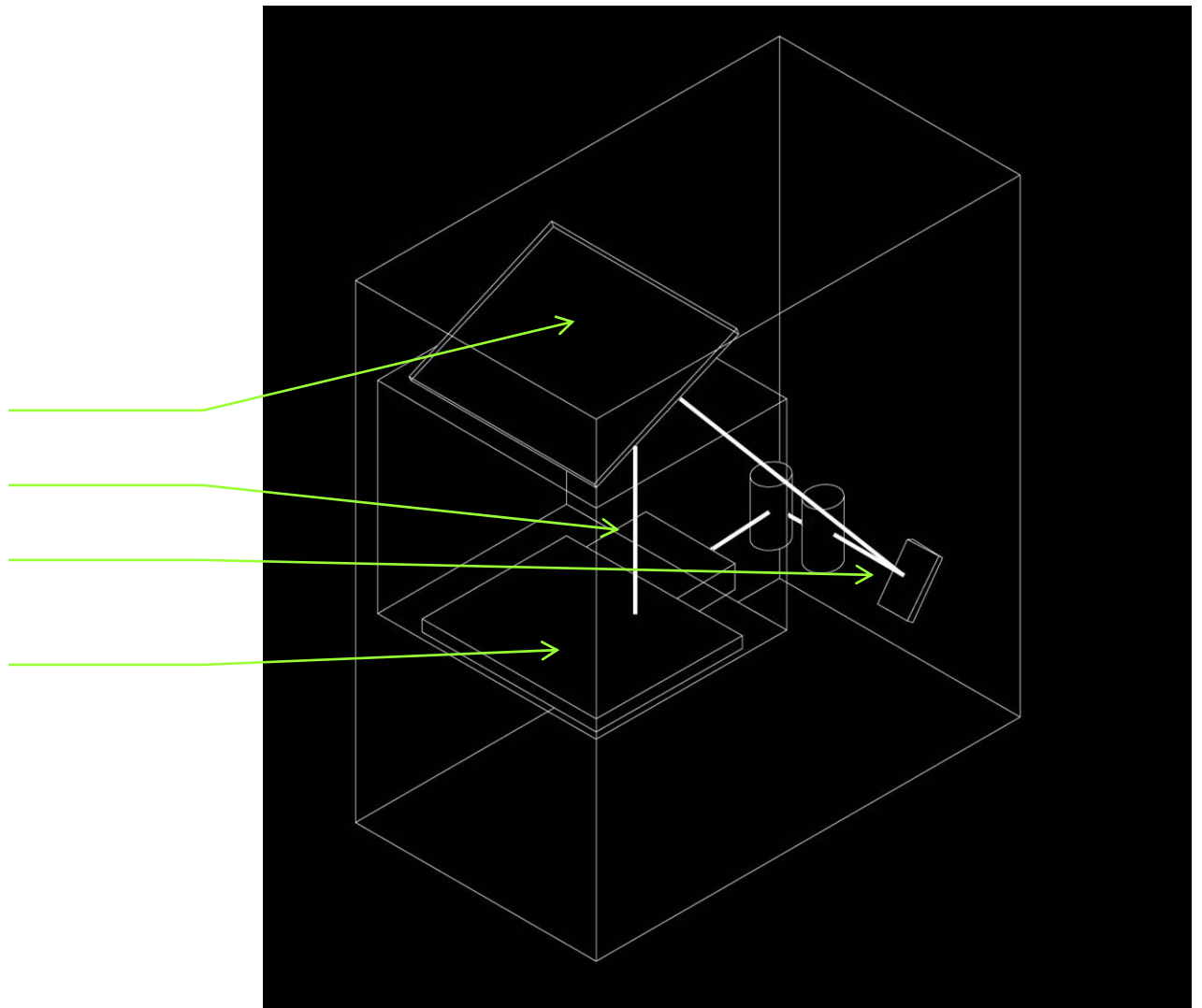

Laser Source

Models

Table

Vat

